



PROSPETTO SU VIA OMERO



PROSPETTO SU CORTILE INTERNO





AREA CONDOMINIALE



ATRIO SCALE PIANO RIALZATO



SOGGIORNO



INGRESSO / DISIMPEGNO

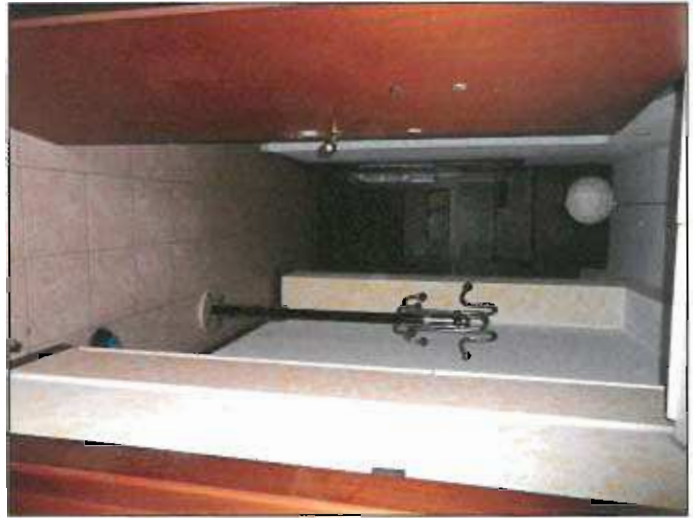



ANGOLO COTTURA

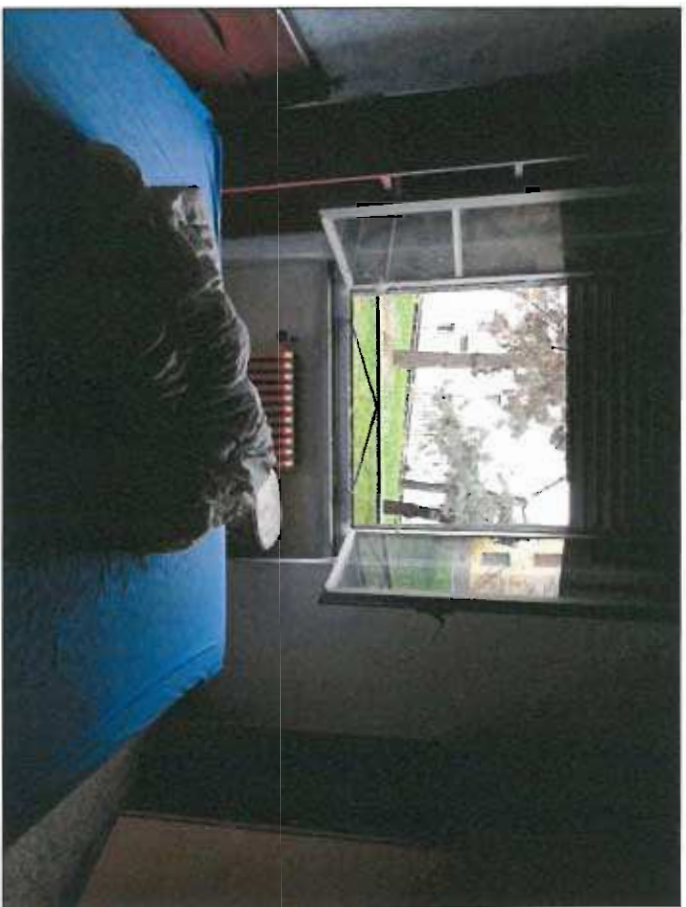

CAMERA DA LETTO



CANTINA



BAGNO

